

American

MORTUARY COOLERS & EQUIPMENT



**Introducing
The AMC
Model #55
Pages 8-9**



**SPECIAL FINANCING
90 DAYS
SAME AS CASH
ON QUALIFIED PURCHASES**

**2019 Cooler & Equipment Catalog
1-888-792-9315**



Recent Installation

Shackelford Cremation, Inc.

Shackelford Funeral Directors, Selmer, TN

Turn-key project including our new AMC Model #55 complete with 10 body rack system and multi-directional roller scissor lift with built in scale. This new installation increased the capacity of only 3 bodies (pictured below) to a total of 13 with the new Model #55.

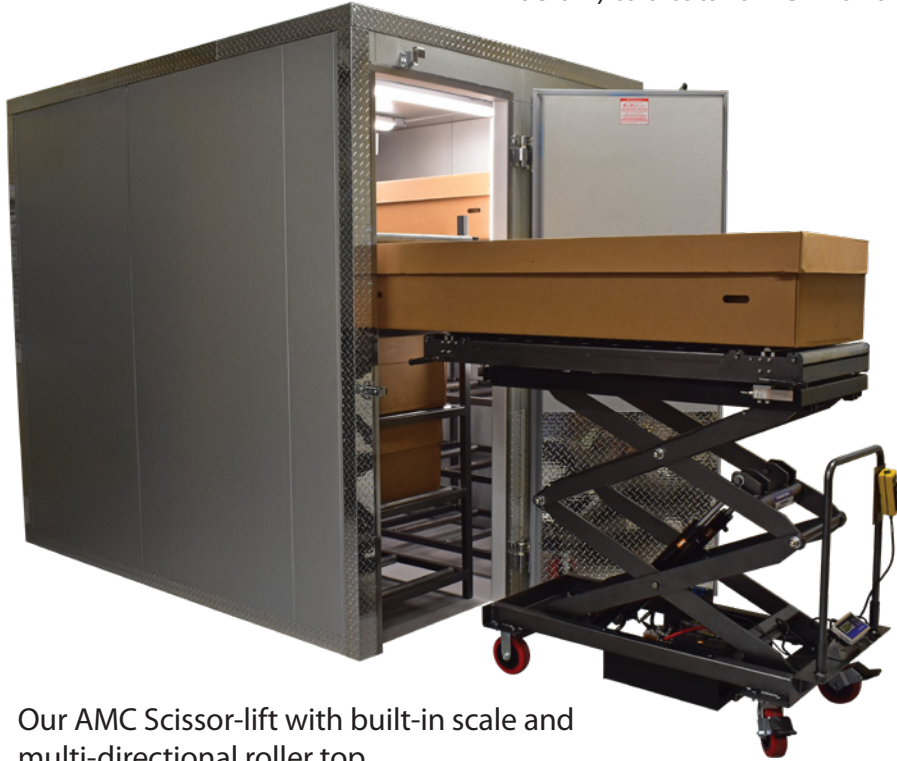

Our AMC Scissor-lift with built-in scale and multi-directional roller top.



The Model #55 includes two 5 tier racks, capable of holding a standard cremation box.



Existing 3 body cooler will now serve as overflow.

Glossary

Rolling Racks.....	4
Storage Racks	5
Heavy Duty Lifts	6
Body Trays & Boards.....	7
Upright Coolers	8-19
Walk-In Coolers.....	20-29
Dressing Tables.....	30
Table Value Packs	31
Embalming Tables & Lifts	32-33
Church Trucks	34
Church Truck Drapes	35
Mortuary Cots.....	36
Mortuary Stretchers.....	37
EVAC Sled & Body Bags.....	38-39



2019 Convention Schedule

CANA Cremation Symposium	February 5th-February 7th	Las Vegas Nevada
ICCFA Annual Convention.....	April 2nd-April 9th	Charlotte, North Carolina
Tennessee Funeral Directors	June 2nd-June 3rd	Sevierville, TN
CANA 101st Annual Convention	July 31st.....	Louisville, Kentucky
NFDMA Morticians Convention	August 3rd-August 8th.....	Mobile, Alabama
NFDA Annual Convention.....	October 27-October 30th.....	Chicago, Illinois

Series A1000 Custom Rolling Rack System

Custom fabricated to customer specifications.



Let's Get Started!

Available heights from two (2) to eight (8) tiers, lengths from one (1) column to virtually any length the customer requires. Rack is available in various heights, lengths, and widths. Dimensions based solely around the customer's needs and requirements.

Required information when requesting a quote

1. Dimensions of the room Length x Width x Height. Any light fixtures also need to be taken into consideration for height purposes.
2. If using an existing cold storage area, provide the Length x Width of the door.
3. We also require the BTU's of the cold storage space (if using an existing space)
4. We offer full installation services on the A1000 series, if you require installation please let us know in the initial contact.
5. Would you like to take advantage of our 100% financing program? Same day decision available in most cases.

Purchase with a new walk-in or for an existing cold storage space

**CUSTOM PRICED TO
FIT YOUR NEEDS
CALL TODAY!**

**100% FINANCING
AVAILABLE**

Quick Ship Body Storage Racks

Our most popular body racks with a fast lead time!



Pictured in end-load
9" Loading Height



Pictured in side-load
21" Loading Height



3 Body Configuration
Side Load - \$1,895
End Load - \$1,795
add Body Board \$216 ea

3 Body Configuration
OD 85" Long x 31" Wide x 55" High
ID 82" Long x 28" Wide
x 16.25" Between Each Level
21" Floor to 1st Level

4 Body Configuration
Side Load - \$2,095
End Load - \$1,985
add Body Board \$216 ea

4 Body Configuration
OD 85" Long x 31" Wide x 75" High
ID 82" Long x 28" Wide
x 16.25" Between Each Level
21" Floor to 1st Level

Body Boards are not included and must be purchased separately

Heavy Duty Lift

Heavy Duty Powered Crematory Lift

\$5,989
~~\$6,959~~

- LCD digital weight scale (Optional \$625.00 add)
- Over 1000 lbs weight capacity
- Industrial Strength
- 12V DC Power (Charger included)
- Made specific for crematory and mortuary Use
- Universal for easy handling of caskets cremation boxes & body trays
- Roller Locks
- Low Height: 22.5" High Height: 76"
- 62.5" X 25" Top Surface



SPECIAL FINANCING
90 DAYS
SAME AS CASH
ON QUALIFIED PURCHASES

Economy Hydraulic Crematory Lift

The unit is easy to maneuver on high impact castors with wheel locks.

- 1300 lbs Weight Capacity
- Double Scissor Lift, Industrial Strength
- Made specific for Crematory and Mortuary Use
- Ideal for easy handling of Caskets, Cremation Boxes & Body Trays
- Multi-directional top
- 72" X 31" Overall
- 20.5" Low | 76" Highest Position



\$3,919
~~\$4,599~~

Body Trays and Boards

Premium Stainless Steel Trays



- Fabricated with hand slots and without a drain hole
- Can be used with various rack storage systems
- Inside corners are finished smooth for easy cleaning
- All edges rolled and welded for extra strength
- Length: 78" (198cm)
x Height: 2.75"(6cm)

23" Width Trays
Weight Capacity: 400lbs.
Gauge: 18

\$459.00

27" Width Trays
Weight Capacity: 500 lbs.
Gauge: 16

\$558.00

30" Width Trays
Weight Capacity: 600 lbs.
Gauge: 14

\$799.00

High Density Plastic Board



\$189
EACH

Length: 76.00" (193 cm)
Width: 23.00" (58 cm)
Height: .50" (1 cm)
Weight: 35 lbs. (16 Kg)

Economy Plastic Storage Board

Product size (L x W x H): (72.5"X18"X2")

Weighs 19 lbs.

Color may vary depending
on availability



\$159
EACH

10 Body Upright

MODEL #AMC 55

Special intro pricing
includes cooler, two 5 tier racks
and 10 body boards.

\$14,819

Compared to
Mortech's 10 body
"Combo Price"
\$16,500

NEW FOR 2019!
3-4 WEEK LEAD TIME
GUARANTEED!



10 Body Upright

MODEL #AMC 55

Internal/External Specifications:

External (O.D.): 9'6" x 7'0" x 9' - w x d x h
Internal (I.D.): 8'11-1/4" x 6'5-1/4" x 8'5" - w x d x h
Capacity: Up to 10 bodies with rack system. (not included)*
Door Openings: 33" Wide x 94" High (2 doors)
Door Swing: Our door swings open a full radius flush with the walk-in.
Door Hinge Locations: Customer chooses left or right hand side for each door
Wall/Ceiling Thickness: 3.5" UL Listed class 1 foam
Wall/Ceiling Finishes: Acrylume/Embossed 26 gauge

Compressor Specifications:

H: 17.5" W: 28.5" L: 52"	
Weight of compressor: 207 lbs.	
Voltage: 208-230/1 phase/60Hz	
Amps: 9.5	MCA: 11.5
BTU: 6,860	CFM: 550
Plug In Type: NEMA 6-15R	
Power Cord Length: 4'	
Refrigerant/Gas: R404A	
Average Operating Temperature: 35° - 43° (Temperature depends on the climate of the environment)	



Additional accessories, upgrades, and warranties:

Item#	Description	Price
XW-M55	Extended 1 year Labor Warranty, outside the 90 days included. This covers 100% 24/7 labor call and 100% of any parts needed. This is a highly recommended add on. One after hours service call can cost up to \$750.00.	\$190.00
58CL	Add locking handle, includes a keyed door and 2 keys. This unit comes standard with a key less door.	\$155.00
ABB-1	Add laminated body board (not included with the unit)	\$216.00
75LC	Temperature/Door Alarm with Light Control/Panic Alarm (Alarm system requires field installation by a certified electrician 120v).	\$789.00
1806V	Add Vapor Proof Light Fixture 110 Volt, includes fixture only. (Installed by customer).	\$179.00
DP36	Add 36" high chrome to the lower exterior of the door	\$185.00
DP36-2	Add 36" high chrome to the lower exterior and interior of the door	\$359.00
DP-EC	Add full chrome kit including 3"x 3" corner protective pieces (all 4 corners) and 6" strips between each corner, spanning the door side of the cooler only.	\$624.00

Customer Installation

Installation on the Model #55 takes approximately 3-4 hours and requires a minimum of 3 people to install. A full instruction sheet is included within the hardware box. Customer is fully responsible for installation not limited to electrical and any HVAC requirements.



Shipping charges and applicable sales tax are not included

TOLL FREE: 1-888-792-9315 | TOLL FREE FAX: 1-800-987-2430

3 Body Extra Large Cooler

MODEL #AMC 3BX

Designed for 3 XL or standard remains, either boxed or on a body board.
Our largest and most popular mobile upright design.

\$5,649
~~\$6,456~~

Interior Rolling Rack Specifications

Item# **AAR-3BX**

Overall Height: 38.5"
Exterior Width: 35"
Interior Width: 33"
Overall Length: 80"
Interior Length: 77"
Vertical space between tiers: 16.25"

**Tiers are welded together and not adjustable*

*Casters not included in sale price.
**Pictured with left hand hinge configuration
***Interior Rolling Rack not included



3 Body Extra Large Cooler

MODEL #AMC 3BX

Internal/External Specifications:

External (O.D.): 3' 6 3/4" x 7' 6" x 5' 2" - w x d x h	
Internal (I.D.): 3' x 6' 11 1/4" x 4' 6 3/4" - w x d x h	
Capacity: 3 XL bodies	Door Opening: 36" Wide x 54" High
Door Swing: Our door swing open a full radius flush with the walk-in.	
Door Hinge Location: Customer chooses left or right hand side	
Upgraded Rolling Rack: Customer can upgrade to a XL 3-tier rolling rack when ordering. See add on section for pricing.	
Wall/Ceiling Thickness: 3.5" UL Listed class 1 foam	
Wall/Ceiling Finishes: Acrylume/Embossed 26 gauge (interior/ exterior)	
Floor Thickness: 3.875" UL Listed Class 1 Foam	
Casters: Can be added as additional accessories (not included in price)	

Compressor Specifications:

H: 15.3"	W: 24.1"	L: 24.4"
Weight of compressor: 88 lbs.		
Roof Opening: 14.5"x20.75"		
Voltage: 115 v/1 phase/ 60 Hz		
Unit Type: PSC Motor/Self-contained		
Amps: 5.9	BTU: 2,610	
MCA: 7.4	MOPD: 15	
Evaporator CFM: 340		
Plug In Type: 5-20R		
Power Cord Length: 4'		
Average Operating Temperature: 35° - 43° <small>(Operating temperature depends on the surrounding environment)</small>		



Additional accessories, upgrades, and warranties:

Item#	Description	Price
AC-3BX	Add 4 swivel casters, factory installed when ordering assembled or un-assembled*.	\$265.00
Assembly	Factory Assembled & Crated (Customer must provide forklift, or other mean of off loading)	\$275.00
58CL	Add locking handle, includes a keyed door and 2 keys. This unit comes standard with a key less door.	\$155.00
ARR-3BX	Add stationary 3-tier rolling rack, boards not included. (This option removes/ substitutes the 3 included body boards.) (The 3BX racks are stationary and are not mobile)	\$898.00
XW-3BX	Extended 1 year Labor Warranty, outside the 90 days included. This covers 100% 24/7 labor call and 100% of any parts needed. This is a highly recommended add on. One after hours service call can cost up to \$750.00.	\$190.00
75LC	Temperature/Door Alarm with Light Control/Panic Alarm (Alarm system requires field installation by a certified electrician 120v).	\$789.00
DP36	Add 36" high chrome to the lower exterior of the door	\$185.00
DP36-2	Add 36" high chrome to the lower exterior and interior of the door	\$359.00
DP-EC	Add full chrome kit including 3"x 3" corner protective pieces (all 4 corners) and 6" strips between each corner, spanning the door side of the cooler only.	\$624.00

Customer Installation (when receiving unit unassembled)*

Installation on the Model#3BX takes approximately 1-2 hours and requires a minimum of 2 people to install. A full instruction sheet is included within the hardware box. This is the most simple unit we offer for customer installation. Customer is fully responsible for installation not limited to electrical and any HVAC requirements.



Shipping charges and applicable sales tax are not included

TOLL FREE: 1-888-792-9315 | TOLL FREE FAX : 1-800-987-2430

Triple Cot Roll-In

MODEL #AMC TR3

Can hold 3 dressing tables or 3 cots, features a 63" door opening. Simply open the door, and roll in. No lifts needed. This unit cannot be shipped assembled. Simple customer install instructions included.

\$6,487
~~\$6,744~~

Finance for as low as
\$112.56 per month



*Cots not included



Front View

Pictured with item
#DP36 (not included)



Rear View

Triple Cot Roll-In

MODEL #AMC TR3

Internal/External Specifications:

External (O.D.): 8' 1" x 7' 4" x 5' 0" - w x d x h
Internal (I.D.): 7' 6 1/4" x 6' 9 1/4" x 4' 8 5/8" - w x d x h
Capacity: Holds up to 3 bodies
Door Opening: 63" Wide x 51" High (Includes inside emergency release handle).
Door Swing: Our door swing open a full radius flush with the walk-in.
Wall/Ceiling Thickness: 3.375" UL Listed class 1 foam
Wall Finish: Acrylume/Embossed - 26 ga.
Ceiling Finish: Acrylume/Embossed - 26 ga./Galvanized/Embossed - 26 ga.
Floor: No floor needed, unit installs on top of a hard surface floor, concrete, tile, or any other masonry based floor. The weight of the compressor, walls, ceilings, and doors proportion the weight appropriately.

Compressor Specifications:

H: 15.3"	W: 24.1"	L: 24.4"
Weight of compressor: 88 lbs.		
Roof Opening: 14.5" x 20.75"		
Voltage: 115 v/1 phase/ 60 Hz		
Unit Type: PSC Motor/Self-contained		
Amps: 9.3	BTU: 4,360	
MCA: 11.3	MOPD: 15	
Evaporator CFM: 340		
Plug In Type: 5-20R		
Power Cord Length: 4'		
Average Operating Temperature: 35° - 43° (Operating temperature depends on the surrounding environment)		



Additional accessories, upgrades, and warranties:

Item#	Description	Price
XW-TR3	Extended 1 year Labor Warranty, outside the 90 days included. This covers 100% 24/7 labor call and 100% of any parts needed. This is a highly recommended add on. One after hours service call can cost up to \$750.00.	\$287.00
ARR-TR3	Add 3-tier rolling rack, boards not included. The TR3 will hold up to 2 rolling racks. (The TR3 racks are stationary and are not mobile)	\$1,179.00
ABB-1	Add laminated body board (not included with the unit)	\$216.00
75LC	Temperature/Door Alarm with Light Control/Panic Alarm (Alarm system requires field installation by a certified electrician 120v).	\$789.00
1806V	Additional Vapor Proof Light Fixture 110 Volt, includes fixture only. (Installed by customer). This unit includes 1 fixture.	\$179.00
58CL	Add locking handle, this specially designed handle utilizes a customer provided padlock for a sleek look.	\$125.00
DP36	Add 36" high chrome to the lower exterior of the door	\$185.00
DP36-2	Add 36" high chrome to the lower exterior and interior of the door	\$259.00
DP-EC	Add full chrome kit including 3"x 3" corner protective pieces (all 4 corners) and 6" strips between each corner, spanning the door side of the cooler only.	\$1,124.00

Customer Installation

Installation on the Model#TR3 takes approximately 3-4 hours and requires a minimum of 2 people to install. A full instruction sheet is included within the hardware box. Customer is fully responsible for installation not limited to electrical and any HVAC requirements.



Shipping charges and applicable sales tax are not included

\$4,019

Single Cot Roll-In Style Cooler

MODEL #AMC 1BR

Our most simple and affordable design. Designed for one standard mortuary cot to roll in. Like all of our units, this unit is 100% American Made.

Great for small funeral homes



***Cot not included**

Single Cot Roll-In Style Cooler

MODEL #AMC 1BR

Internal/External Specifications:

External (O.D.): 3' 3/4" x 7' 6" x 5' 2" - w x d x h	
Internal (I.D.): 2' 6" x 6' 11 1/4" x 4' 10 5/8" - w x d x h	
Door Opening: 30" Clear opening	
Door Swing: Our door swing open a full radius flush with the walk-in.	
Door Hinge Location: Customer chooses left or right hand side	
Wall/Ceiling Thickness: 3.5" UL Listed class 1 foam	
Wall/Ceiling Finishes: Acrylume/Embossed 26 gauge (interior/ exterior)	
Floor: Not available for this unit	Body Board: Not included



Compressor Specifications:

H: 15.3" W: 24.1" L: 24.4"	
Weight of compressor: 88 lbs.	
Roof Opening: 14.5"x20.75"	
Voltage: 115 v/1 phase/ 60 Hz	
Unit Type: PSC Motor/Self-contained	
Amps: 5.9	BTU: 2,610
MCA: 7.4	MOPD: 15
Evaporator CFM: 340	
Plug In Type: 5-20R	
Power Cord Length: 4'	
Average Operating Temperature: 35° - 43° <small>(Operating temperature depends on the surrounding environment)</small>	



Additional accessories, upgrades, and warranties:

Item#	Description	Price
XW-1BR	Extended 1 year Labor Warranty, outside the 90 days included. This covers 100% 24/7 labor call and 100% of any parts needed. This is a highly recommended add on. One after hours service call can cost up to \$750.00.	\$190.00
Assembly	Factory Assembled & Crated (Customer must provide forklift, or other mean of offloading)	\$285.00
58CL	Add locking handle, includes a keyed door and 2 keys. This unit comes standard with a key less door.	\$155.00
75LC	Temperature/Door Alarm with Light Control/Panic Alarm (Alarm system requires field installation by a certified electrician 120v).	\$789.00
1806V	Add Vapor Proof Light Fixture 110 Volt, includes fixture only. (Installed by customer).	\$179.00
DP36	Add 36" high chrome to the lower exterior of the door	\$185.00
DP36-2	Add 36" high chrome to the lower exterior and interior of the door	\$359.00
DP-EC	Add full chrome kit including 3"x 3" corner protective pieces (all 4 corners) and 6" strips between each corner, spanning the door side of the cooler only.	\$624.00

Customer Installation

Installation on the Model#1BR takes approximately 3-4 hours and requires a minimum of 2 people to install. A full instruction sheet is included within the hardware box. Customer is fully responsible for installation not limited to electrical and any HVAC requirements.



Order# 284694

Shipping charges and applicable sales tax are not included

TOLL FREE: 1-888-792-9315 | TOLL FREE FAX: 1-800-987-2430

Two Body Cot Roll-In Style Cooler

MODEL #AMC 2BR

Our most simple and affordable design.
Designed for one mortuary cot to roll in
under top rack assembly.

\$4,209
~~\$4,984~~



SPECIAL FINANCING
90 DAYS
SAME AS CASH
ON QUALIFIED PURCHASES



Two Body Cot Roll-In Style Cooler

MODEL #AMC 2BR

Internal/External Specifications:

External (O.D.): 3' 3/4" x 7' 6" x 5' 2" - w x d x h	
Internal (I.D.): 2' 6" x 6' 11 1/4" x 4' 10 5/8" - w x d x h	
Door Opening: 30" Clear opening	
Door Swing: Our door swing open a full radius flush with the walk-in.	
Door Hinge Location: Customer chooses left or right hand side	
Wall/Ceiling Thickness: 3.5" UL Listed class 1 foam	
Wall/Ceiling Finishes: Acrylume/Embossed 26 gauge (interior/ exterior)	
Floor: Not available for this unit	Body Board: Includes 1 body board

Compressor Specifications:

H: 15.3" W: 24.1" L: 24.4"	
Weight of compressor: 88 lbs.	
Roof Opening: 14.5" x 20.75"	
Voltage: 115 v/1 phase/ 60 Hz	
Unit Type: PSC Motor/Self-contained	
Amps: 5.9	BTU: 2,610
MCA: 7.4	MOPD: 15
Evaporator CFM: 340	
Plug In Type: 5-20R	
Power Cord Length: 4'	
Average Operating Temperature: 35° - 43° <small>(Operating temperature depends on the surrounding environment)</small>	



Additional accessories, upgrades, and warranties:

Item#	Description	Price
58CL	Add locking handle, includes a keyed door and 2 keys. This unit comes standard with a key less door.	\$155.00
XW-2BR	Extended 1 year Labor Warranty, outside the 90 days included. This covers 100% 24/7 labor call and 100% of any parts needed. This is a highly recommended add on. One after hours service call can cost up to \$750.00.	\$190.00
Assembly	Factory Assembled & Crated (Customer must provide forklift, or other mean of offloading)	\$275.00
75LC	Temperature/Door Alarm with Light Control/Panic Alarm (Alarm system requires field installation by a certified electrician 120v).	\$789.00
DP36	Add 36" high chrome to the lower exterior of the door	\$199.00
DP36-2	Add 36" high chrome to the lower exterior and interior of the door	\$359.00
DP-EC	Add full chrome kit including 3"x 3" corner protective pieces (all 4 corners) and 6" strips between each corner, spanning the door side of the cooler only.	\$624.00

Customer Installation

Installation on the Model#2BR takes approximately 1-2 hours and requires a minimum of 2 people to install. A full instruction sheet is included within the hardware box. Customer is fully responsible for installation not limited to electrical and any HVAC requirements.



Shipping charges and applicable sales tax are not included

Two Body Cot Roll-In Extra Large

MODEL #AMC 2BRX

\$5,449
~~\$5,789~~



*Cot not included



Two Body Cot Roll-In Extra Large

MODEL #AMC 2BRX

Internal/External Specifications:

External (O.D.): 3' 7 3/4" x 7' 6" x 5' 2" - w x d x h
Internal (I.D.): 3' 1" x 6' 11 1/4" x 4' 10 5/8" - w x d x h
Capacity: 3 XL bodies
Door Opening: 36" Clear opening
Door Swing: Our door swing open a full radius flush with the walk-in.
Door Hinge Location: Customer chooses left or right hand side
Upgraded Rolling Rack: Customer can upgrade to a XL 3-tier rolling rack when ordering. See add on section for pricing.
Wall/Ceiling Thickness: 3.5" UL Listed class 1 foam
Wall/Ceiling Finishes: Acrylume/Embossed 26 gauge (interior/ exterior)

Compressor Specifications:

H: 15.3"	W: 24.1"	L: 24.4"
Weight of compressor: 88 lbs.		
Roof Opening: 14.5" x 20.75"		
Voltage: 115 v/1 phase/ 60 Hz		
Unit Type: PSC Motor/Self-contained		
Amps: 5.9	BTU: 2,610	
MCA: 7.4	MOPD: 15	
Evaporator CFM: 340		
Plug In Type: 5-20R		
Power Cord Length: 4'		
Average Operating Temperature: 35° - 43° <small>(Operating temperature depends on the surrounding environment)</small>		



Additional accessories, upgrades, and warranties:

Item#	Description	Price
58CL	Add locking handle, includes a keyed door and 2 keys. This unit comes standard with a key less door.	\$155.00
Assembly	Factory Assembled & Crated (Customer must provide forklift, or other mean of offloading)	\$275.00
XW-2BRX	Extended 1 year Labor Warranty, outside the 90 days included. This covers 100% 24/7 labor call and 100% of any parts needed. This is a highly recommended add on. One after hours service call can cost up to \$750.00.	\$190.00
75LC	Temperature/Door Alarm with Light Control/Panic Alarm (Alarm system requires field installation by a certified electrician 120v).	\$789.00
DP36	Add 36" high chrome to the lower exterior of the door	\$185.00
DP36-2	Add 36" high chrome to the lower exterior and interior of the door	\$359.00
DP-EC	Add full chrome kit including 3" x 3" corner protective pieces (all 4 corners) and 6" strips between each corner, spanning the door side of the cooler only.	\$624.00

Customer Installation

Installation on the Model#2BRX takes approximately 1-2 hours and requires a minimum of 2 people to install. A full instruction sheet is included within the hardware box. Customer is fully responsible for installation not limited to electrical and any HVAC requirements.



Shipping charges and applicable sales tax are not included unless otherwise specified.

TOLL FREE: 1-888-792-9315 | TOLL FREE FAX : 1-800-987-2430

8'x10' Walk-In

MODEL #AMC 0810



\$8,596
~~\$10,150~~

SPECIAL FINANCING
90 DAYS
SAME AS CASH
ON QUALIFIED PURCHASES

Door can be placed anywhere you choose. Please specify when ordering



*Pictured above with two 3 tier side load racks. Not included in price.

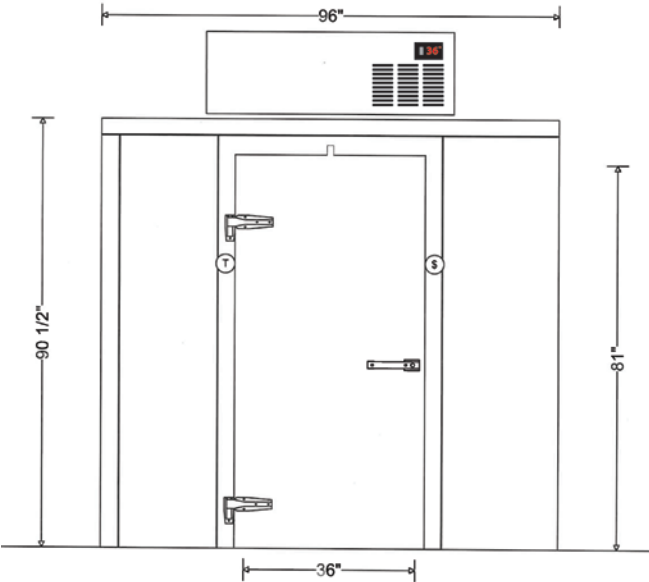

8'x10' Walk-In

MODEL #AMC 0810

Internal/External Specifications:

External (O.D.): 8' 0" x 10' 0" x 7' 6 1/2" - w x d x h
Internal (I.D.): 7' 5" x 9' 5" x 7' 3" - w x d x h
Capacity: Holds up to 8 bodies with rack system. (not included)*
Door Opening: 36" Wide x 81" High (Includes inside emergency release handle).
Door Swing: Our door swing open a full radius flush with the walk-in.
Wall/Ceiling Thickness: 3.5" UL Listed class 1 foam
Wall/Ceiling Finish: Acrylume/Embossed - 26 ga.
Floor: Floor not included*, unit installs on top of a hard surface floor, concrete, tile, or any other masonry based floor. The weight of the compressor, walls, ceilings, and doors proportion the weight appropriately. Floor model #AF-0810 is available below if required.

Compressor Specifications:

H: 17.5" W: 28.5" L: 52"	
Weight of compressor: 207 lbs.	
Voltage: 208-230/1 phase/60Hz	
Amps: 9.5	MCA: 11.5
BTU: 6,860	CFM: 550
Plug In Type: NEMA 6-15R	
Power Cord Length: 4'	
Refrigerant/Gas: R404A	
Average Operating Temperature: 35° - 43° (Temperature depends on the climate of the environment)	



Upgrade to Larger Door Size:

Standard Door Size is 36"

42"	\$355.00
46"	\$395.00
52"	\$495.00

Additional accessories, upgrades, and warranties:

Item#	Description	Price
58CL	Add locking handle, includes a keyed door and 2 keys. This unit comes standard with a key less door.	\$155.00
XW-0810	Extended Labor Warranty, outside the 90 days included. This covers 100% 24/7 labor call and 100% of any parts needed. This is a highly recommended add on. One after hours service call can cost up to \$750.00.	\$391.00
75LC	Temperature/Door Alarm with Light Control/Panic Alarm (Alarm system requires field installation by a certified electrician 120v).	\$789.00
DP36	Add 36" high chrome to the lower exterior of the door	\$195.00
DP36-2	Add 36" high chrome to the lower exterior and interior of the door	\$329.00
DP-EC	Add full chrome kit including 3"x 3" corner protective pieces (all 4 corners) and 6" strips between each corner, spanning the door side of the cooler only.	\$1,119.00
AF-0810*	Add interior floor with 24" interior ramp	\$1,679

Customer Installation

Installation on the Model#0810 takes approximately 3-4 hours and requires a minimum of 3 people to install. A full instruction sheet is included within the hardware box. Customer is fully responsible for installation not limited to electrical and any HVAC requirements.



Shipping charges and applicable sales tax are not included

Order# 253572

TOLL FREE: 1-888-792-9315 | TOLL FREE FAX: 1-800-987-2430

10'x10' Walk-In

MODEL #AMC1010

\$9,147
~~\$9,750~~

Finance for as low as
\$161.20 per month



Includes top mounted compressor

SPECIAL FINANCING
90 DAYS
SAME AS CASH
ON QUALIFIED PURCHASES

*Pictured with custom side mount compressor. Call for pricing.
**Custom height walk-in with minimal ceiling clearance.

Door can be placed anywhere you choose. Please specify when ordering

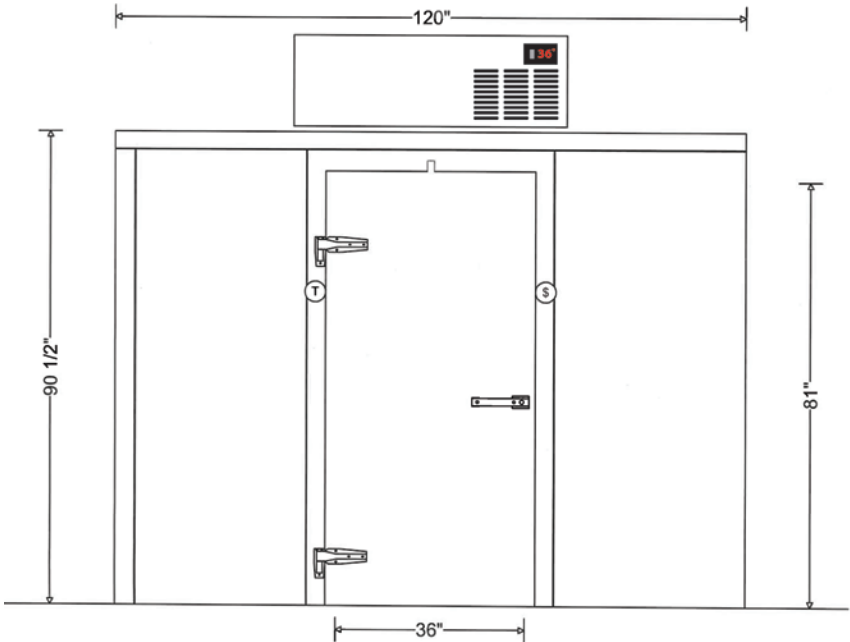
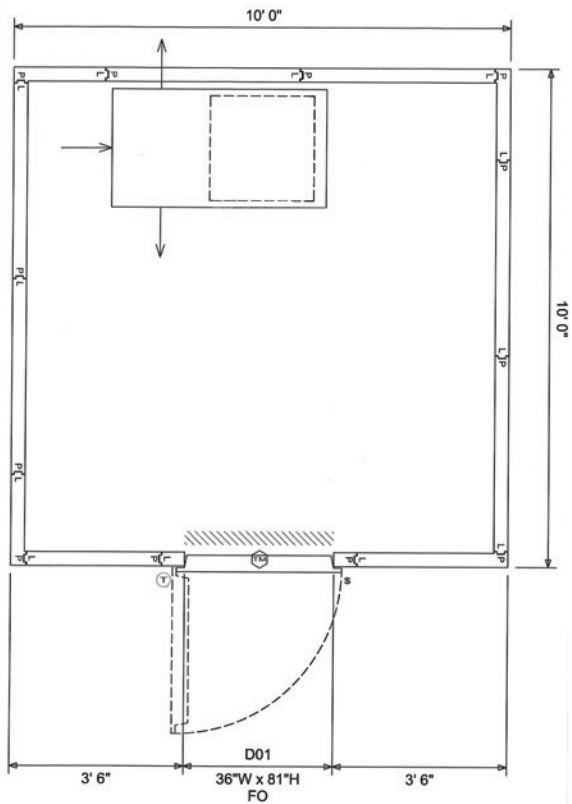

10'x10' Walk-In

MODEL #AMC1010

Internal/External Specifications:

External (O.D.): 10' 0" x 8' 0" x 7' 6 1/2" - w x d x h
Internal (I.D.): 9' 5" x 7' 5" x 7' 3" - w x d x h
Capacity: Holds up to 12 bodies with rack system. (not included)*
Door Opening: 36" Wide x 81" High (Includes inside emergency release handle).
Door Swing: Our door swing open a full radius flush with the walk-in.
Wall/Ceiling Thickness: 3.5" UL Listed class 1 foam
Wall/Ceiling Finish: Acrylume/Embossed - 26 ga.
Floor: Floor not included*, unit installs on top of a hard surface floor, concrete, tile, or any other masonry based floor. The weight of the compressor, walls, ceilings, and doors proportion the weight appropriately. Floor model #AF-1010 is available below if required.

Upgrade to Larger Door Size: Standard Door Size is 36"

42"	\$355.00
46"	\$395.00
52"	\$495.00

Compressor Specifications:

H: 17.5" W: 28.5" L: 52"	
Weight of compressor: 207 lbs.	
Voltage: 208-230/1 phase/60Hz	
Amps: 9.5	MCA: 11.5
BTU: 7,500	CFM: 550
Plug In Type: NEMA 6-15R	
Power Cord Length: 4'	
Refrigerant/Gas: R404A	
Average Operating Temperature: 35° - 43° (Temperature depends on the climate of the environment)	



Additional accessories, upgrades, and warranties:

Item#	Description	Price
XW-1010	Extended Labor Warranty, outside the 90 days included. This covers 100% 24/7 labor call and 100% of any parts needed. This is a highly recommended add on. One after hours service call can cost up to \$750.00.	\$385.00
AF-1010	Add interior floor with 24" interior ramp	\$1,879
75LC	Temperature/Door Alarm with Light Control/Panic Alarm (Alarm system requires field installation by a certified electrician 120v).	\$789.00
1806V	Additional Vapor Proof Light Fixture 110 Volt, includes fixture only. (Installed by customer). This unit includes 1 fixture.	\$179.00
58CL	Add locking handle, includes a keyed door and 2 keys. This unit comes standard with a key less door.	\$155.00
DP36	Add 36" high chrome to the lower exterior of the door	\$185.00
DP36-2	Add 36" high chrome to the lower exterior and interior of the door	\$299.00
DP-EC	Add full chrome kit including 3"x 3" corner protective pieces (all 4 corners) and 6" strips between each corner, spanning the door side of the cooler only.	\$1,124.00

Customer Installation

Installation on the Model#1010 takes approximately 3-4 hours and requires a minimum of 3 people to install. A full instruction sheet is included within the hardware box. Customer is fully responsible for installation not limited to electrical and any HVAC requirements.



Shipping charges and applicable sales tax are not included

Order# 253572

TOLL FREE: 1-888-792-9315 | TOLL FREE FAX : 1-800-987-2430

10'x 15' Walk-In

MODEL #AMC1015

\$10,425
~~\$10,956~~

Finance for as low as
\$183.72 per month



SPECIAL FINANCING
90 DAYS
SAME AS CASH
ON QUALIFIED PURCHASES



Door can be placed anywhere you choose. Please specify when ordering

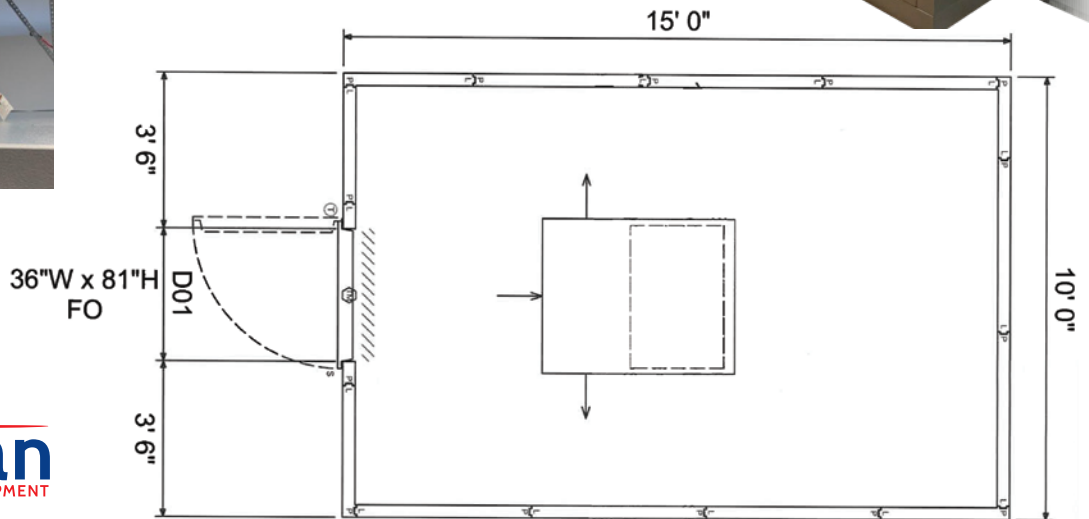

10'x 15' Walk-In

MODEL #AMC1015

Internal/External Specifications:

External (O.D.): 10' 0" x 15' 0" x 7' 6 1/2" - w x d x h
Internal (I.D.): 9' 5" x 14' 5" x 7' 3" - w x d x h
Capacity: Holds up to 18 bodies with rack system. (not included)*
Door Opening: 36" Wide x 81" High (Includes inside emergency release handle).
Door Swing: Our door swing open a full radius flush with the walk-in.
Wall/Ceiling Thickness: 3.5" UL Listed class 1 foam
Wall/Ceiling Finish: Acrylume/Embossed - 26 ga.
Floor: Floor not included*, unit installs on top of a hard surface floor, concrete, tile, or any other masonry based floor. The weight of the compressor, walls, ceilings, and doors proportion the weight appropriately. Floor model #AF-1015 is available below if required.

Compressor Specifications:

H: 17.5" W: 28.5" L: 52"	
Weight of compressor: 265 lbs.	
Voltage: 208-230/1 phase/60Hz	
Amps: 12.4	MCA: 14.8
BTU: 11,190	CFM: 875
Plug In Type: NEMA 6-15R	
Power Cord Length: 4'	
Refrigerant/Gas: R404A	
Average Operating Temperature: 35° - 43° (Temperature depends on the climate of the environment)	

Upgrade to Larger Door Size: Standard Door Size is 36"

42"	\$355.00
46"	\$395.00
52"	\$495.00



Additional accessories, upgrades, and warranties:

Item#	Description	Price
XW-1015	Extended Labor Warranty, outside the 90 days included. This covers 100% 24/7 labor call and 100% of any parts needed. This is a highly recommended add on. One after hours service call can cost up to \$750.00.	\$395.00
AF-1015	Add interior floor with 24" interior ramp	\$2,879
75LC	Temperature/Door Alarm with Light Control/Panic Alarm (Alarm system requires field installation by a certified electrician 120v).	\$789.00
1806V	Additional Vapor Proof Light Fixture 110 Volt, includes fixture only. (Installed by customer). This unit includes 1 fixture.	\$179.00
58CL	Add locking handle, includes a keyed door and 2 keys. This unit comes standard with a key less door.	\$155.00
DP36	Add 36" high chrome to the lower exterior of the door	\$185.00
DP36-2	Add 36" high chrome to the lower exterior and interior of the door	\$279.00
DP-EC	Add full chrome kit including 3"x 3" corner protective pieces (all 4 corners) and 6" strips between each corner, spanning the door side of the cooler only.	\$1,324.00

Customer Installation

Installation on the Model#1015 takes approximately 4-5 hours and requires a minimum of 3 people to install. A full instruction sheet is included within the hardware box. Customer is fully responsible for installation not limited to electrical and any HVAC requirements.



Shipping charges and applicable sales tax are not included

Order# 253572

TOLL FREE: 1-888-792-9315 | TOLL FREE FAX : 1-800-987-2430

25

10'x 20' Walk-In

MODEL #AMC-1020

Finance for as low as
\$212.29 per month

\$12,046
~~\$13,650~~

SPECIAL FINANCING
90 DAYS
SAME AS CASH
ON QUALIFIED PURCHASES

Door can be placed
anywhere you choose. Please
specify when ordering

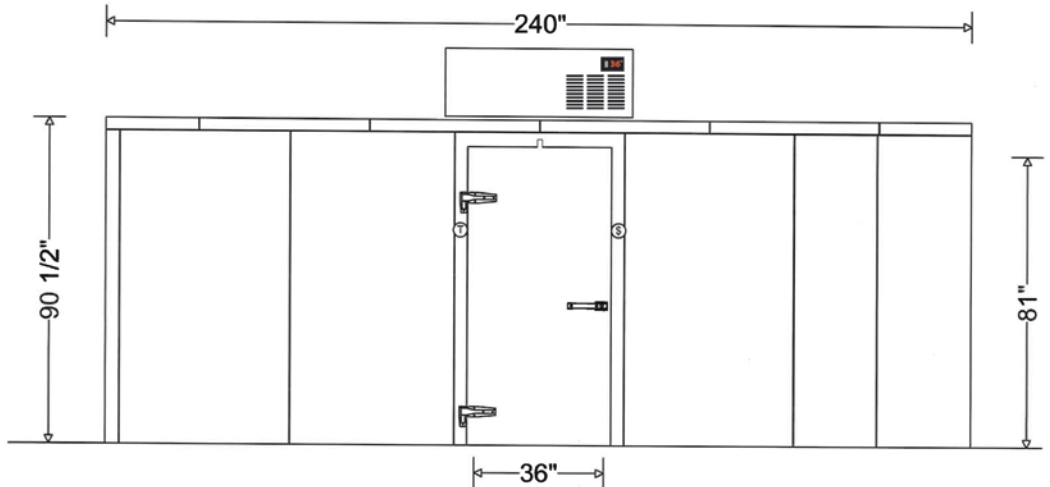

10' x 20' Walk-In

MODEL #AMC-1020

Internal/External Specifications:

External (O.D.): 10' 0" x 20' 0" x 7' 6 1/2" - w x d x h
Internal (I.D.): 9' 5" x 19' 5" x 7' 3" - w x d x h
Capacity: Holds up to 24 bodies with rack system. (not included)*
Door Opening: 36" Wide x 81" High (Includes inside emergency release handle).
Door Swing: Our door swing open a full radius flush with the walk-in.
Wall/Ceiling Thickness: 3.5" UL Listed class 1 foam
Wall/Ceiling Finish: Acrylume/Embossed - 26 ga.
Floor: Floor not included*, unit installs on top of a hard surface floor, concrete, tile, or any other masonry based floor. The weight of the compressor, walls, ceilings, and doors proportion the weight appropriately. Floor model #AF-1020 is available below if required.

Compressor Specifications:

H: 17.5" W: 28.5" L: 52"	
Weight of compressor: 290 lbs.	
Voltage: 208-230/1 phase/60Hz	
Amps: 12.4	MCA: 14.8
BTU: 12,790	CFM: 825
Plug In Type: NEMA 6-20R	
Power Cord Length: 4'	
Refrigerant/Gas: R404A	
Average Operating Temperature: 35° - 43° (Temperature depends on the climate of the environment)	

Upgrade to Larger Door Size: Standard Door Size is 36"

42"	\$355.00
46"	\$395.00
52"	\$495.00



Additional accessories, upgrades, and warranties:

Item#	Description	Price
XW-1020	Extended Labor Warranty, outside the 90 days included. This covers 100% 24/7 labor call and 100% of any parts needed. This is a highly recommended add on. One after hours service call can cost up to \$750.00.	\$425.00
75LC	Temperature/Door Alarm with Light Control/Panic Alarm (Alarm system requires field installation by a certified electrician 120v).	\$789.00
1806V	Additional Vapor Proof Light Fixture 110 Volt, includes fixture only. (Installed by customer). This unit includes 1 fixture.	\$179.00
58CL	Add locking handle, includes a keyed door and 2 keys. This unit comes standard with a key less door.	\$155.00
DP36	Add 36" high chrome to the lower exterior of the door	\$185.00
DP36-2	Add 36" high chrome to the lower exterior and interior of the door	\$359.00
DP-EC	Add full chrome kit including 3"x 3" corner protective pieces (all 4 corners) and 6" strips between each corner, spanning the door side of the cooler only.	\$1,524.00
AF-1020	Add interior floor with 24" interior ramp	\$3,201

Customer Installation

Installation on the Model#1020 takes approximately 4-5 hours and requires a minimum of 3 people to install. A full instruction sheet is included within the hardware box. Customer is fully responsible for installation not limited to electrical and any HVAC requirements.



Shipping charges and applicable sales tax are not included

Order# 253572

TOLL FREE: 1-888-792-9315 | TOLL FREE FAX: 1-800-987-2430

20'x 20' Walk-In

MODEL #AMC-2020

\$15,984

~~\$18,350~~

Finance for as low as

\$292.65 per month

SPECIAL FINANCING

90 DAYS
SAME AS CASH
ON QUALIFIED PURCHASES

Door can be placed anywhere
you choose. Please specify when
ordering

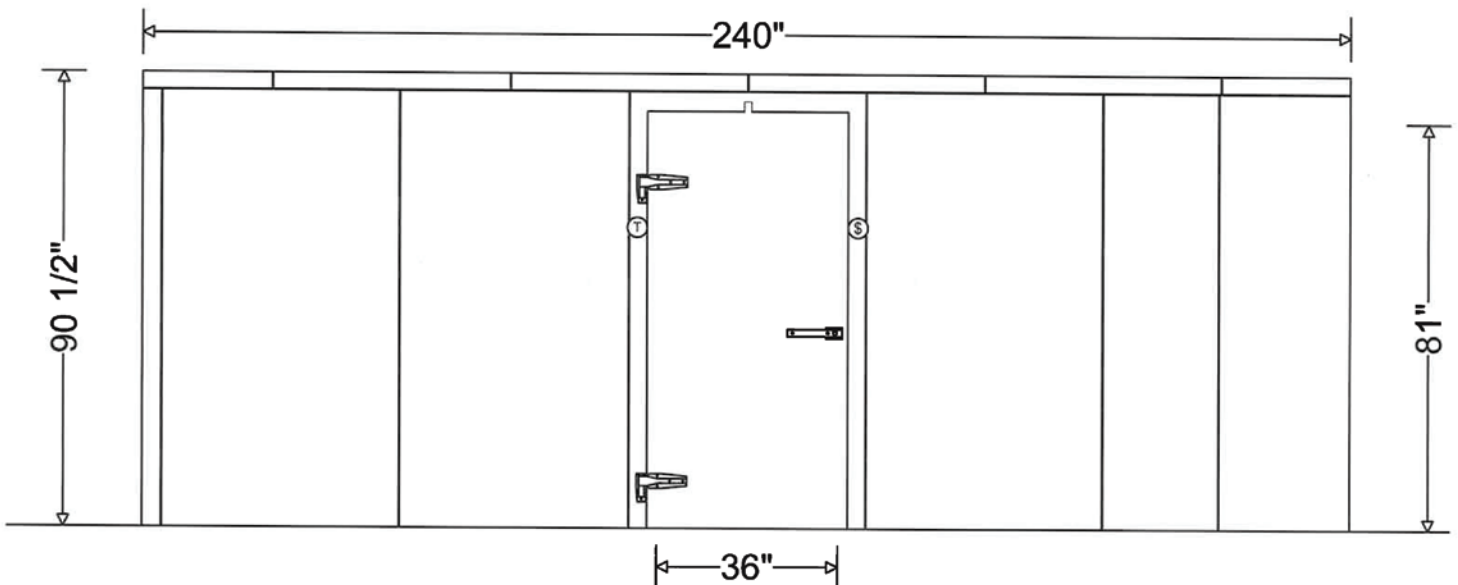
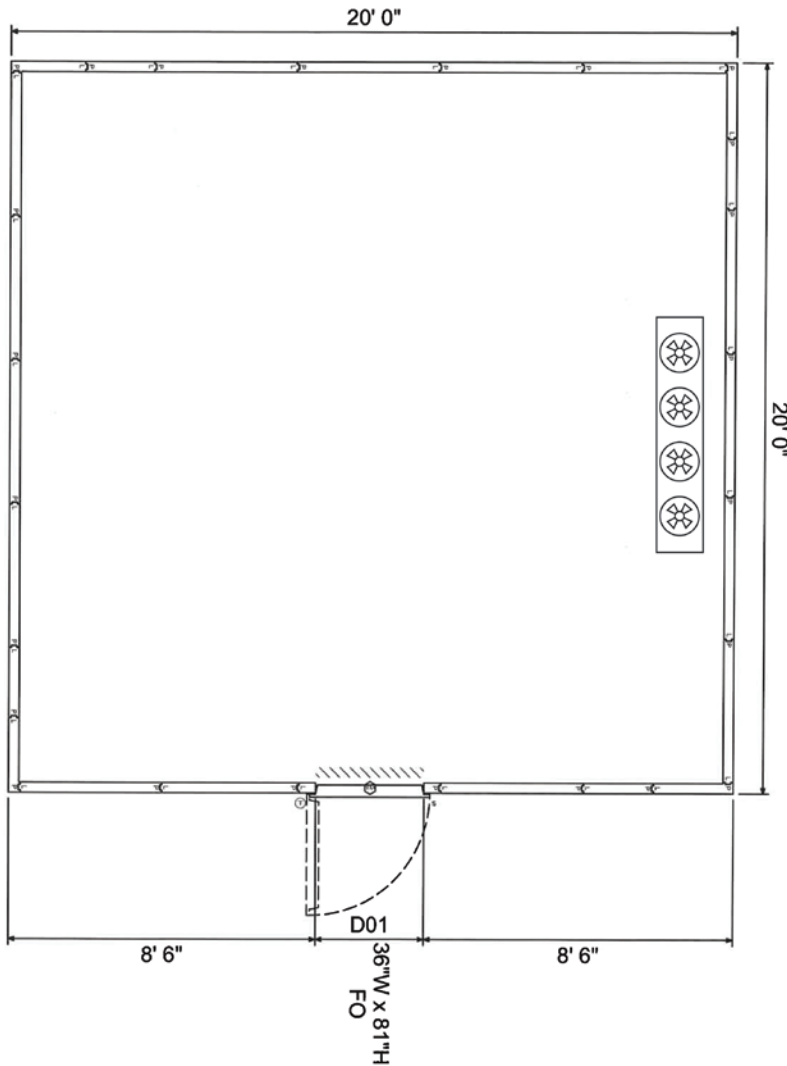

20' x 20' Walk-In

MODEL #AMC-2020

Internal/External Specifications:

External (O.D.): 20' 0" x 20' 0" x 7' 6 1/2" - w x d x h
Internal (I.D.): 19' 5" x 19' 5" x 7' 3" - w x d x h
Capacity: Holds up to 48 bodies with rack system. (not included)*
Door Opening: 36" Wide x 81" High (Includes inside emergency release handle).
Door Swing: Our door swing open a full radius flush with the walk-in.
Wall/Ceiling Thickness: 3.5" UL Listed class 1 foam
Wall/Ceiling Finish: Acrylume/Embossed - 26 ga.
Floor: Floor not included*, unit installs on top of a hard surface floor, concrete, tile, or any other masonry based floor. The weight of the compressor, walls, ceilings, and doors proportion the weight appropriately. Floor model #AF-2020 is available below if required.

Condensing Unit Specifications:

BTUH: 17,490	Amps: 12.8
Voltage: 208-230/1 phase/60Hz	
Horsepower: 2.5	
RLA: 11.2	MOPD: 25
MCA: 15	
Refrigerant/Gas: R404 (not included)*	
Unit Type: Hermetic Remote Outdoor	

Evaporator Unit Specifications:

Air defrost Low profile coil (unit cooler) with EC fan motors coil. TXV, Liquid line, Solenoid valve, T-stat (Mechanical).	
Voltage: 115/1/60,	
Fan amps: 3.8	EC Fan Motor Coil

Upgrade to Larger Door Size: Standard Door Size is 36"

42"	\$355.00
46"	\$395.00
52"	\$495.00



Questions?
1-888-792-9315

Additional accessories, upgrades, and warranties:

Item#	Description	Price
58CL	Add locking handle, includes a keyed door and 2 keys. This unit comes standard with a key less door.	\$155.00
75LC	Temperature/Door Alarm with Light Control/Panic Alarm (Alarm system requires field installation by a certified electrician 120v).	\$789.00
XW-2020	Extended Labor Warranty, outside the 90 days included. This covers 100% 24/7 labor call and 100% of any parts needed. This is a highly recommended add on. One after hours service call can cost up to \$750.00.	\$625.00
1806V	Additional Vapor Proof Light Fixture 110 Volt, includes fixture only. (Installed by customer).	\$179.00
DP36	Add 36" high chrome to the lower exterior of the door	\$185.00
DP36-2	Add 36" high chrome to the lower exterior and interior of the door	\$399.00
DP-EC	Add full chrome kit including 3"x 3" corner protective pieces (all 4 corners) and 6" strips between each corner, spanning the door side of the cooler only.	\$2,124.00
AF-2020*	Add interior floor with 24" interior ramp	\$4,499

Customer Installation

Installation on the Model#2020 takes approximately 5-6 hours and requires a minimum of 3 people to install. A full instruction sheet is included within the hardware box. Customer is fully responsible for installation not limited to electrical and any HVAC requirements.



Order# 253572

Shipping charges and applicable sales tax are not included

TOLL FREE: 1-888-792-9315 | TOLL FREE FAX: 1-800-987-2430

Dressing Tables

Why pay \$1,398 or more?? **SAVE BIG!**



STANDARD SIZE
AS LOW AS
\$895
EACH

OVERSIZED
AS LOW AS
\$995
EACH

110% BEST PRICE GUARANTEE

SPECIAL FINANCING

90 DAYS
SAME AS CASH
ON QUALIFIED PURCHASES

Standard 25"

Standard Width

Overall size: L77" x W25" x H34"
Folded size: H59" x W25" x H13"
Weight: 68 lbs
Load Capacity: 500 lbs

STANDARD PRICE PER TABLE

1-3 \$987
4+ \$895



Oversized Width
Model# FS1 034XL
(patent pending)



Standard Width
Model# FS1 034S

Oversized 32"

Oversize Width

Overall size: L77" x W32" x H34"
Folded size: H59" x W32" x H13"
Weight: 68 lbs
Load Capacity: 700 lbs

OVERSIZE PRICE PER TABLE

1-3 \$1,099
4+ \$995



 2 Year Metal Frame
Warranty

Prep Table Value Packs

DEAL ONE

- 1 Hydraulic Embalming Table (Item# FS1 1001OS)
- 1 Standard Folding Dressing Table (Model# 034S)
- 1 Oversized Dressing Table (Model# 034XL)

\$4,724

~~\$5,104~~

DEAL TWO

- 2 Standard Folding Dressing Tables (Model# 034S)
- 2 Oversized Dressing Tables (Model# 034XL)

\$3,699

~~\$4,172~~

DEAL THREE

- 2 Hydraulic Embalming Tables (Item# FS1 1001OS)
- 1 Standard Folding Dressing Table (Model# 034S)
- 1 Oversized Dressing Table (Model# 034XL)

\$6,999

~~\$7,876~~

DEAL FOUR

- 4 Standard Folding Dressing Tables (Model# 034S)
- 1 Oversized Dressing Table (Model# 034XL)

\$3,860

~~\$4,575~~

DISCLAIMER: Deals may not be combined with other offers. All offers subject to availability at the time order is placed. Shipping and applicable sales tax is not included in sale price.

Embalming Tables

SALE!

Hydraulic Embalming Table

2 OR MORE
\$2,895
EACH

110% BEST PRICE GUARANTEE

INDIVIDUAL
\$3,018
EACH

35" Oversized Table Top



Item# FS1 1001OS
(Head Block Not Included)

SPECIAL FINANCING
90 DAYS
SAME AS CASH
ON QUALIFIED PURCHASES

**Removable
Safety Bars**

Stainless Steel Top
Length: 85", Width: 35"
Height: 4.5"
Weight: 107 lbs (49kg)

Hydraulic Base
Length: 63", Width: 29"
Height: 24"
Weight 128lbs (58kg)



Ships Freight 

Shipping charges & applicable taxes are not included in the price advertised

Embalming Tables & Lifts



\$1,744
EACH

2 OR MORE
\$1,599
EACH

Stainless Steel Combination Embalming & Dressing Table

Model#ET-1013

Specifications:

Load Limit: 700 lbs

80" x 30" (L x W)

Wheelbase: 69.5" x 27"

Max Height: 38.5"

\$1,299
EACH



Hydraulic Body Lifter **1000lb Capacity**

Extra heavy-duty casket and body lifter can easily handle up to 1000 lbs. With its nine 4" swivel casters, you can easily maneuver this body lifter through a door-way. Features adjustable body carriage, which allows you to adjust all 4 body straps with ease. Comes with four 2" adjustable washable nylon web body straps, which can adjust to the girth of any body. Ships ready to use. Includes a 3 year warranty on the hydraulic cylinder.

Body Bridge Set

Model#38BB

Length: 25.00"

Width: 4.00"

Height Max: 3.00"



\$199.65
PER SET

**TOP
SELLER!**

Replacement Body Lift Straps

\$109
PER SET

Set of 4 adjustable
PR-StrapsSt



Church Trucks

SALE!

Heavy Duty Church Truck

1200 POUND LOAD CAPACITY

4 OR MORE
\$469
EACH

110% BEST PRICE GUARANTEE

2 OR MORE
\$489
EACH

INDIVIDUAL
\$509
EACH



Item# 087R Silver



Item# 087R Gold



Item# 087R Black

Fully Extended Height: 21.5"
Length: 61" (55 x 155 cm)
Locked Position Height: 24" Length: 51" (61 x 130 cm)
Locked Position Height: 27" Length: 29" (69 x 74 cm)
Fully Collapsed Height: 29" Length: 5" (74 x 13 cm)
Weight: 35 lbs. (16 kg) Capacity 1200 Lbs.
All Colors Guaranteed In Stock!



Item# 087R Bronze

Casket Jack Set

- Step on Lever
- Supports up to 1000 lbs.

\$189
PER SET

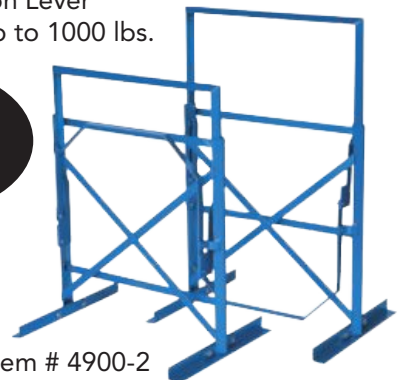

Item # 4900-2

Church Truck Drapes

Frameless Church Truck Drapes



\$299
EACH



Item # 087-DRAPE

\$259
EACH WITH
CHURCH TRUCK
PURCHASE

Available In

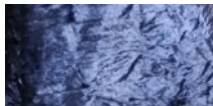

Navy Blue



Onyx Black



Burgundy



Slate Gray

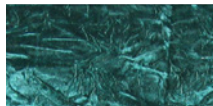

Green

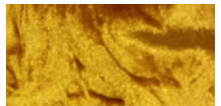

Gold

Double Sided Casket Drape

110% BEST PRICE GUARANTEE



\$765
PER SET

Item # CB-4005-2

- Doudrape (2-sided) complete with frame.
 - In your choice of colors.
- Five fold metal wire frame holds drape in position.
- Special corner hinges allows you to fit any casket corner.
 - Snug fit every time.
- Fits front and two sides of casket, around church truck.

Measurements: 22" H x 132" L



Mortuary Cots



All cots include a free basic cover, and 2 sets of straps. All of our equipment is brand new in the box.

One Man Standard Mortuary Cot

Model #FS1-S500

Length: 76.00"
Width: 22.00"
Height Max: 40.20"
Height Min: 14.00"
Loading Height (distance from the bottom of the load wheels to the ground): 24.00"
Weight: 65 lbs.
Load Limit: 550 lbs.
2 Stationary & 2 Swivel Wheels



\$1,149
EACH

500 POUND CAPACITY
(22" wide)

One Man Standard Width 1000 LB. Capacity 21" Wide

Model #FS1-S1000

Length: 78.00"
Width: 21.00"
Height Max: 32.50"
Height Min: 10.00"
Loading Height (distance from the bottom of the load wheels to the ground): 24.00"
Weight: 70 lbs.
Load Limit: 1000 lbs.
2 Stationary & 2 Swivel Wheels



\$2,059
EACH

1000 POUND CAPACITY
(21" wide)

Oversized Mortuary Cot 24.8" Wide

Model #FS1-Ultra1000

Length: 77.00"
Width: 24.80" (53 cm)
Height Max: 41.20"
Height Min: 14.00"
Loading Height (distance from the bottom of the load wheels to the ground): 24.00"
Weight 80 lbs.
Load Limit: 1000 lbs.
2 Stationary & 2 Swivel Wheels



SALE!
\$1,795
EACH

1000 POUND CAPACITY
(24.8" wide)

All Cots 1 Year Limited Warranty

All Cots Ship Assembled

All Cots Include Straps



Mortuary Stretchers

Oversized EZ Slider

23 5/8" Wide x 72" Long

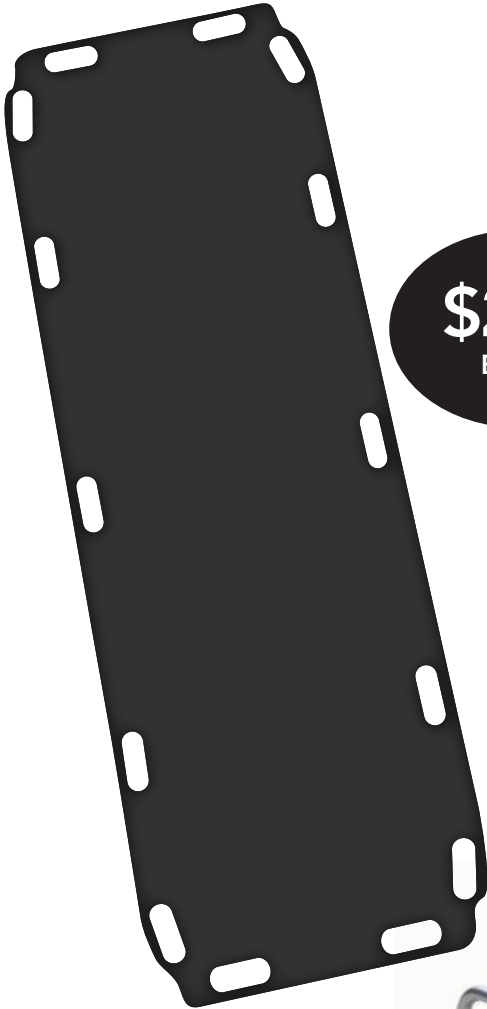

\$215
EACH

SALE!

Standard EZ Slider

72.25" Long x 18.25" Wide



\$159
EACH



Easy Fold Stretcher with Body Bag Attachment

Model #FS1-602-WB

Size: 82" X 21" X 14"

Weight: 21 Lbs.

Load Capacity: 375 Lbs.

fabric color may vary*



\$409
EACH

\$309
EACH



Easy Folding Stretcher w/Wheels

Model #FS1-602

74" L x 21" W x 14" H

Load Capacity: 375 Lbs.

Great for upstairs/
bathrooms

EVAC Sled & Body Bags



\$329

Portable EVAC Sled

- Ideal for confined areas and evacuations
- Smooth surface allows easy sliding
- Durable lightweight construction



Ultra Heavy Duty Disaster Pouch

6 handles are riveted to the unit to ensure transport in the roughest conditions
Seams are heat sealed to be impervious for the HIGH risk of exposure regulations
42" wide x 90" long
600 pound capacity
Colors: Black
Packaged per case of 4 units

AS LOW AS
\$139
PER CASE

1-4 Cases \$149.00 per case
5+ Cases \$139.00 per case



SALE!

AS LOW AS
\$109
PER CASE

Heavy Duty Body Bag

Dimensions: 36" x 94" x 10 mils
Weight capacity: 375 lbs
Zipper style: Curved with 2 zipper pulls
Packaged per case of 10 units

1-4 Cases \$116.00 per case
5+ Cases \$109.00 per case



Portable Stretchers

\$369
EACH

Standard Model Flexible Stretcher

Item#FC-SFS1

- Three Cross web straps secure patient within the wrapping flexible stretcher
- Opens to 6'6", closes to 4'10" x 8"
- Internal pockets at both head and foot for storage of patient's belongings, data sheets, etc.
- Five Wooden slats securely sewn in pockets for stiffness and body
- Made in the USA!
- Load Limit: 600 lbs.
- WARRANTY: 5 years



*Pictured in orange.
Also available in gray. Specify when ordering.

Flexible Stretcher With Body Bag Attachment

Item#FC-FSWB1

- Zippered top flap, made of 10 oz vinyl coated nylon
- 3 Web straps secure body for easy transport
- Opens to 6'6" x 28", closes to 4'10" x 8"
- Top cover hood for discrete transport of body
- Five Wooden slats securely sewn in pockets for stiffness and body
- Made in the USA!
- Load Limit: 600 lbs.
- WARRANTY: 5 years

\$469
EACH



Replacement 7' Cot Straps

Two piece set,
1 male/ 1 female
2 sets needed
for each cot

\$35.80
/SET



3 Body Extra Large Cooler

\$5,899

~~\$6,456~~



Dressing Tables

STANDARD SIZE
AS LOW AS
\$895
EACH

OVERSIZED
AS LOW AS
\$995
EACH



SPECIAL FINANCING
90 DAYS
SAME AS CASH
ON QUALIFIED PURCHASES

